

# HPC-7442

## 4U Rackmount/Tower Chassis for EATX/ATX Motherboard with Up to 8 SAS/SATA HDD Trays

**NEW**



### Features

- Supports EATX/ATX motherboard
- Shock-resistant disk drive bay holds four hot-swap 3.5" and 2.5" SAS/SATA disk trays, one slim optical disk drive, and one 3.5" internal drive
- With installation of optional storage upgrade kit, eight hot-swap HDD trays provide high storage capacity
- Supports 80plus single and redundant power supply
- Front-accessible system fan without opening top cover for easy maintenance
- LED indicators and audible alarm notification for system fault detection
- Smart fan speed control for system fans
- Remote management (with SUSIAccess)

Quiet

CE FCC RoHS

### Specifications

Drive Bay	Slim Optical Drive	Front-accessible	Internal
	2.5" or 3.5**	1	-
Cooling	Fan*	4 SAS/SATA HDDs (can upgrade to 8)	1 (3.5")
	Air Filter	Yes	
Front I/O Interface	USB	2	
Miscellaneous	LED Indicators	Power, HDD, temperature, fan, LAN1, and LAN2	
	Rear Panel	Five 9-pin D-Sub and one 68-pin SCSI openings	
Environment	Temperature	Operating	Non-Operating
	Humidity	0 ~ 40° C (32 ~ 104° F)	-40 ~ 70° C (-40 ~ 156° F)
	Vibration (5 ~ 500 Hz)	10 ~ 95% @ 40° C, non-condensing	10 ~ 95% @ 60° C, non-condensing
	Shock	1 Grms	2 G
		10 G (with 11 ms duration, half sine wave)	
Physical Characteristics	Dimensions (W x H x D)	482 x 177 x 600 mm (19" x 7.0" x 23.6")	
	Weight	18.5 kg (40.68 lb)	

\* While adding the optional "storage upgrade kit", the chassis will support four more front-accessible SAS/SATA HDDs and one more (8cm/55CFM)fan for SAS/SATA storage unit.

### Front View

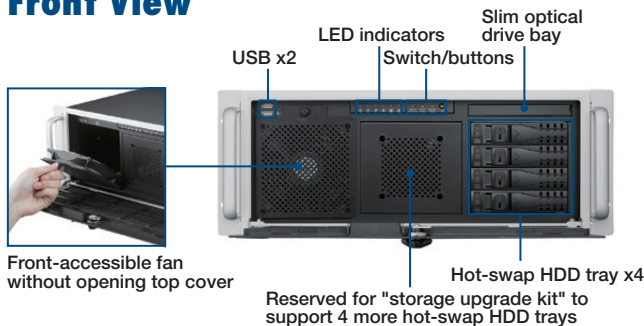

### Inside View

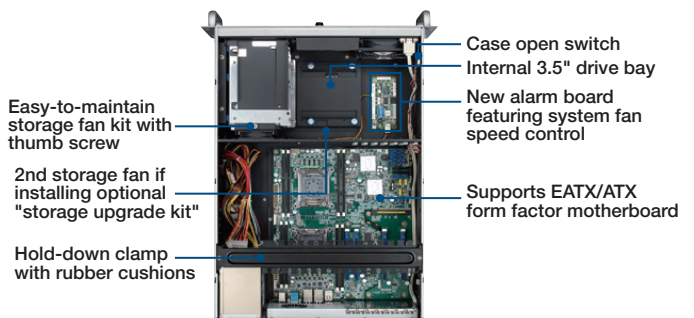

### Upgrade Feature



HPC-7442 default sku (supports 4 hot-swap HDD trays)

+

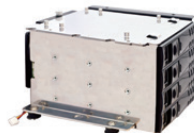

Storage upgrade kit (optional, 9680014979)

=



HPC-7442 8-bay sku (supports 8 hot-swap HDD trays)

\*Note: Motherboard and power supply are not included.

## Dimensions

Unit: mm [inch]

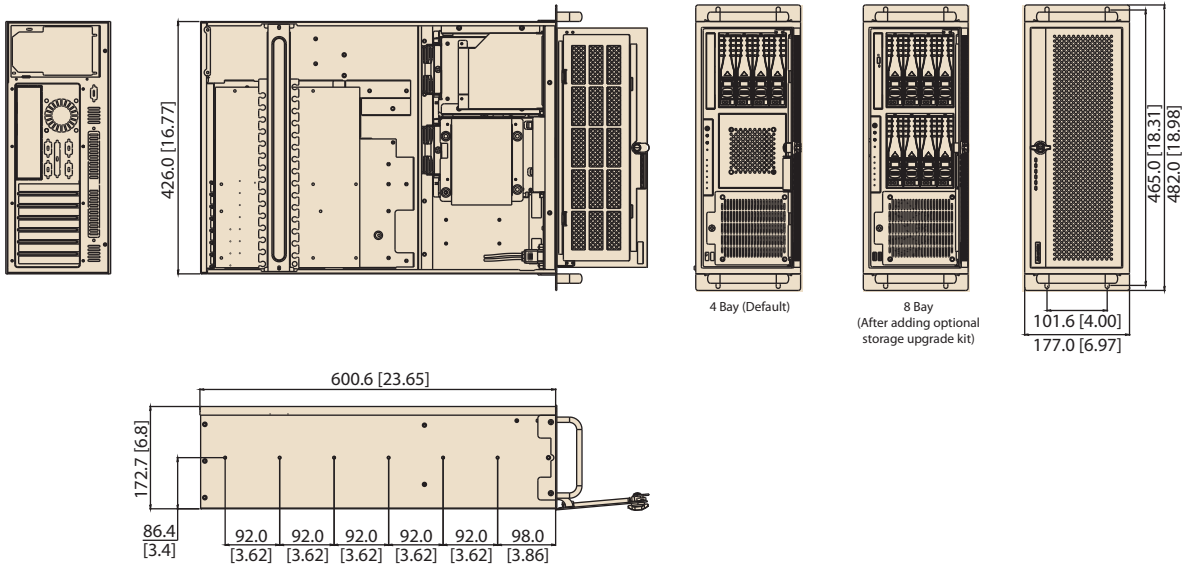

## Ordering Information

Part Number	Power Supply
HPC-7442MB-00XE	Without power supply, with ATX switch

## Power Supply Options

Part Number	Specifications	
	Watts	Input
PS8-400ATX-ZE (ATX, PFC)	400W	AC 100 ~ 240 V (full range)
PS8-500ATX-ZE (ATX, PFC)	500W	AC 100 ~ 240 V (full range)
PS8-700ATX-ZE (ATX, PFC)	700W	AC 100 ~ 240 V (full range)
1757004393-01 (1+1 redundant)	500W	AC 100 ~ 240 V (full range)
TBD (1+1 redundant)	750W	AC 100 ~ 240 V (full range)

## Optional Accessories

Part Number	Description
9680014979	Storage Upgrade Kit (including 4-bay HDD cage, four hot-swap HDD trays, 4-bay HDD backplanes, one cooling fan)
96CB-SATAPOWER-6P1	SATA power wire 6-pin to big 4-pin (for slim ODD)

## Spare Parts

Part Number	Description
9662132020E	Black mobile HDD tray
1990021256T000	Door filter